



Threaded insert
self-tapping with safety groove

Ensat®-SBN
Works Standard
317 and 318

Application

This special threaded insert is used to absorb extreme torsional and vibration stress.

The antirotation function is achieved by means of a parallel notched stud to DIN EN ISO 8740 (pre-drill with diameter E_3 , depth = B_3+1 mm).

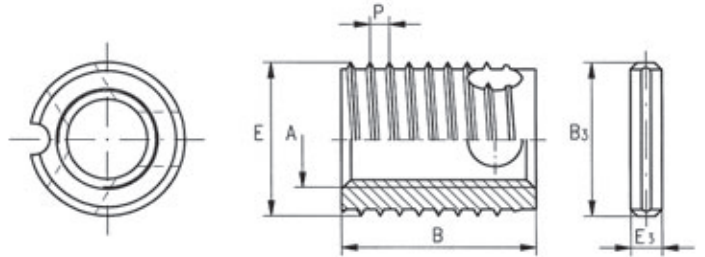

Dimensions in mm

Article number	Internal thread	External thread Special thread		Length	Guideline values for receiving hole diameter	Minimum borehole depth for blind holes	Notched stud	
	A	E	P	B	L	T	B ₃	E ₃
317 000 040 ...	M 4	6,5	0,8	6	6,1 to 6,2	8	4	2
318 000 040 ...	M 4	6,5	0,8	8	6,1 to 6,2	10	6	2
317 000 050 ...	M 5	8	1	7	7,6 to 7,7	9	4	2
318 000 050 ...	M 5	8	1	10	7,6 to 7,7	13	6	2
317 000 060 ...	M 6	10	1,25	8	9,5 to 9,6	10	6	2
318 000 060 ...	M 6	10	1,25	12	9,5 to 9,6	15	10	2
317 000 080 ...	M 8	12	1,5	9	11,3 to 11,5	11	6	2
318 000 080 ...	M 8	12	1,5	14	11,3 to 11,5	17	10	2
317 000 100 ...	M 10	14	1,5	10	13,3 to 13,5	13	6	2
318 000 100 ...	M 10	14	1,5	18	13,3 to 13,5	22	16	2
317 000 120 ...	M 12	16	1,75	12	15,2 to 15,4	15	10	2
318 000 120 ...	M 12	16	1,75	22	15,2 to 15,4	26	16	2
317 000 140 ...	M 14	18	2	14	17,2 to 17,4	17	10	2
318 000 140 ...	M 14	18	2	24	17,2 to 17,4	28	16	2
317 000 160 ...	M 16	20	2	14	19,2 to 19,4	17	10	2
318 000 160 ...	M 16	20	2	24	19,2 to 19,4	28	16	2

Example for finding the article number

Self-tapping threaded insert Ensat®-SBN to Works Standard 317 0 with safety groove and internal thread A = M5 made of case-hardened, zinc plated, thick film passivated steel: Ensat®-SBN 317 000 050.112

Short design
Long design

Works Standard 317
Works Standard 318

Materials

Case-hardened steel, zinc plated, blue passivated
Case-hardened steel, zinc plated, thick film passivated
Case-hardened steel, zinc-nickel plated, transparent passivated
Stainless steel 1.4305

Article no. (**fourth** group of digits) 110
Article no. (**fourth** group of digits) 112
Article no. (**fourth** group of digits) 143
Article no. (**fourth** group of digits) 500

Other materials, designs (e. g. fine thread) and finishes on request.

Material of the notched stud: Ensat® made of steel = Steel, zinc plated
Ensat® made of stainless steel = Stainless steel

Tolerance

ISO 2768-m

Thread

Internal thread A: as per ISO 6H
External thread E: Special thread with flattened thread root, as per KKV standard.
Internal thread UNC, UNF, Whitworth on request